

Capacity (25°C)	20HR (2.90A, 10.8V) = 58.0AH 10HR (5.50A, 10.5V) = 55.0AH 5HR (10.70A, 10.5V) = 53.5AH 1HR (35.30A, 10.5V) = 35.30AH
Operating Temperature Range	Charge = 0°C to 45°C Discharge = -15°C to 50°C Storage = -15°C to 40°C
Approx. Weight	16.50Kg
Internal Resistance	Fully charged at 25°C : ≤ 12mΩ
Self Discharge	3% per month at (25°C)
Capacity Affected by Temp. (20HR)	40°C = 102% 25°C = 100% 0°C = 85% -15°C = 65%
Charge Voltage (25°C)	Cycle Use = 14.4-14.7V (-30mV/°C) Max Current = 16.5A Float Use = 13.5-13.8V (-20mV/°C)
Dimensions (Nominal)	Length: 230mm (9.06 in.) Width: 137mm (5.39 in.) Height: 210mm (8.27 in.) Total Height: 228mm (8.48 in.)

- Completely sealed, maintenance-free, low self-discharge
- State of the art AGM and grid alloy formula technology
- Non-spillable, stable quality and high reliability with excellent re-charging performance
- Floating and standby use up to: 8 years
- Cycle use: Up to 260 cycles at 100% DoD
- Cycle use : Up to 500 Cycles at 50% DoD
- Container and Cover Material – ABS UL94-HB (optional UL94-V0)
- Transportation - D.O.T., I.A.T.A. & F.A.A.



■ APPLICATIONS

Multipurpose
Telecommunications
UPS
Medical Equipment

Alarm & Security System
Comm. Power Supply
Elec. Power System (EPS)
Emergency Backup Power

DC Power Supply
Auto Control System
Traffic Control Signaling
Emergency Lighting

Terminal Type

■ Terminal M

■ Terminal NB

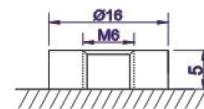
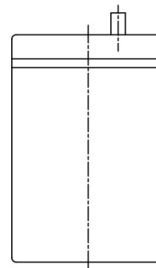
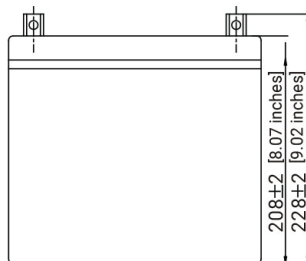
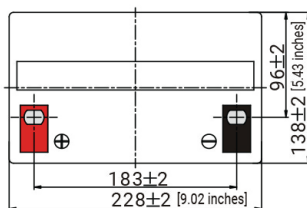

M6 Bolt

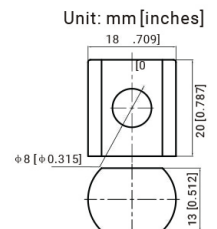

M6 Bolt & Nut

REV V2

