

## 5/5.8kW Single-Phase Switched PDU, Outlet Monitoring, 208/240V Outlets (20 C13 & 4 C19), 0U, LX Platform Interface, TAA

MODEL NUMBER: PDUMVR30HVNETLX

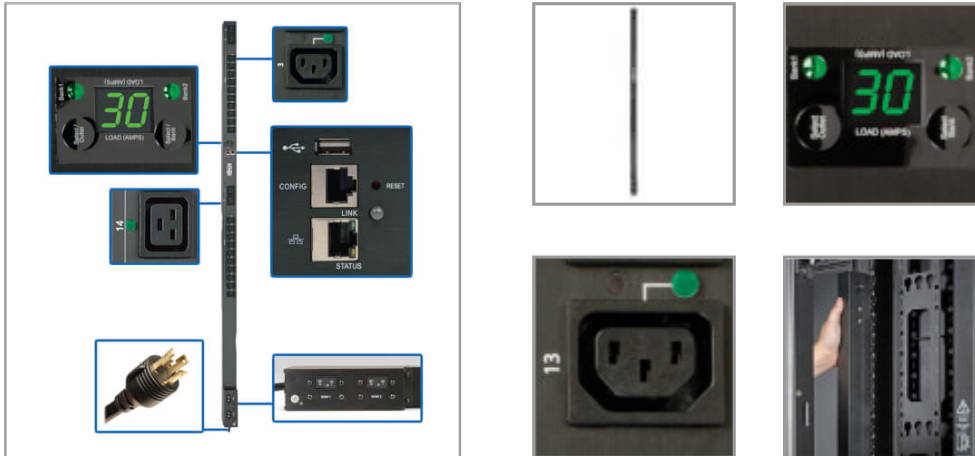

Efficient, cost-effective 5/5.8kW PDU distributes, monitors and manages single-phase power in an IT or industrial environment. Built-in Ethernet interface helps monitor load levels to prevent overloads that cause downtime.

### Description

The PDUMVR30HVNETLX 5/5.8kW Single-Phase Switched PDU provides advanced network control and remote power monitoring with the ability to turn on, turn off, reboot or lock out power to each outlet. Recommended for any IT or industrial application, it features 24 switched outlets (20 C13 and 4 C19). LEDs indicate each outlet's on/off power status, and you can monitor each outlet's power consumption remotely or via digital display. A 10-foot cord with NEMA L6-30P plug connects the PDU to a compatible AC power source, generator or protected UPS.

The built-in Java-free HTML5-based LX Platform interface enables full remote access for power monitoring, configuration, control and email notifications via secure web browser, SNMP, telnet or SSH. It supports 10/100 Mbps auto-sensing for optimum communication with an Ethernet network. Optional EnviroSense2 modules (sold separately) provide a variety of environmental monitoring capabilities. Protocols supported include HTTP, HTTPS, SMTP, SNMPv1, SNMPv2c, SNMPv3, Telnet, SSH, CLI, FTP, DHCP and NTP.

A digital LED meter allows you to monitor each bank's load in real time to ensure the PDUMVR30HVNETLX is used at maximum capacity with no danger of overload. The PDU mounts in 0U of space in EIA-standard 19-inch racks using the included toolless mounting buttons or the included rack-mounting brackets. Use the included PDUMVROTATEBRKT kit to install the unit with outlets facing the rear for better airflow or equipment access.

### Features

**Distributes Network-Grade Single-Phase Power** 5/5.8kW 208/240V 30A switched PDU with single-phase input/output Recommended for network applications requiring individual outlet control, load shedding and remote monitoring of critical network components NEMA L6-30P with 10 ft. cord connects to compatible AC power source

**24 Switched Outlets Distribute AC Power** 20 C13 and 4 C19 outlets split into 2 separate load banks Outlets can be remotely controlled to power up, power down, reboot or lock out unresponsive devices Front-panel LEDs indicate outlets' power status Current monitoring provides 1% billing grade accuracy

### Highlights

- 5/5.8kW 208/240V 30A switched PDU
- 24 switched outlets—20 C13, 4 C19
- Ethernet network interface for remote outlet access 24/7
- Digital meter for load monitoring in real time
- Monitors power consumption of individual outlets
- To enable the Auto Probe feature, this product requires LX firmware update 15.5.2 or later to be installed

### Package Includes

- PDUMVR30HVNETLX 5/5.8kW Single-Phase Switched PDU
- Configuration cable
- (20) C13 plug-lock inserts
- (4) C19 plug-lock inserts
- (2) 90° PDU rotation brackets
- Additional button mounts
- Owner's manual



**Tripp Lite**  
1111 W. 35th Street  
Chicago, IL 60609 USA  
Telephone: 773.869.1234  
www.tripplite.com

**Digital Load Meter** Reports load levels for each bank, both banks combined and each outlet Supports IP-address self-ID Rotates 180° for easy reading at all angles

**Outlet-Level Current Monitoring** Monitors power consumption for each individual outlet remotely or via digital display Tracks current power usage trends per device or input cord

**Advanced Network Monitoring** Built-in LX Platform interface allows full remote access for power monitoring, configuration, control and email notifications via secure web browser, SNMP, telnet or SSH No Java required Automated alerts help prevent accidental overloads, power loss and downtime Optional EnviroSense2 modules (sold separately) provide a variety of environmental monitoring capabilities

**Broad Communications Compatibility** Supports HTTP, HTTPS, PowerAlert, SMTP, SNMPv1, SNMPv2, SNMPv3, telnet, SSH, FTP, DHCP and NTP Supports automatic and manual assignment of IP address

**Reduce Service Calls with Auto Probe Autonomous Device Management** The Auto Probe feature (Firmware 15.5.2 and greater) checks the connectivity status of any networked device and automatically takes one or more user-configured actions if the device fails to respond; actions include outlet reboot, set SNMP traps, SNMP OID sets, and even script execution when used in conjunction with the Tripp Lite PowerAlert Network Shutdown Agent (PANSA)

**Easy 0U Installation in EIA-Standard 19 in. Racks** Mounts vertically using included toolless buttons or rack-mounting brackets Included PDUMVROTATEBRKT allows mounting with rear-facing outlets Plug-lock inserts prevent cables from becoming accidentally disconnected

**TAA-Compliant** Compliant with the Federal Trade Agreements Act (TAA) for GSA Schedule purchases

## Specifications

OVERVIEW	
UPC Code	037332202840
PDU Type	Switched
INPUT	
PDU Input Voltage	200; 208; 240
Recommended Electrical Service	30A 208/240V
Maximum Input Amps	30
Maximum Input Amps Details	Agency de-rated to 24A continuous
PDU Plug Type	NEMA L6-30P
Input Phase	Single-Phase
Input Cord Length (ft.)	10
Input Cord Length (m)	3.05
OUTPUT	
Frequency Compatibility	50 / 60 Hz
Output Capacity Details	5.8kW (240V), 5kW (208V), 4.8kW (200V) total capacity / 30A max (Agency de-rated to 24A), 20A max per breakered outlet bank; 16A max per C19 outlet; 12A max per C13 outlet
Output Receptacles	(20) C13; (4) C19
Output Nominal Voltage	200; 208; 240
Overload Protection	Two 20A breakers protect 12 outlets each
Customized Load Management Receptacles	Each outlet is individually controllable via remote interface



**Tripp Lite**  
1111 W. 35th Street  
Chicago, IL 60609 USA  
Telephone: 773.869.1234  
www.tripplite.com

USER INTERFACE, ALERTS & CONTROLS	
Front Panel LCD Display	Digital display reports load level in amps for LOAD BANK 1 (Outlets 1-12), LOAD BANK 2 (Outlets 13-24), LOAD BANKS 1&2 COMBINED (Outlets 1-24) and each individual output receptacle; Digital display can also be used to scroll the configured IP address
Front Panel LEDs	BANK 1 and BANK 2 LEDs verify which load bank the digital current display is reporting (Bank 1, Bank 2 or Banks 1&2 Combined); BANK 1 or BANK 2 LED will flash when the digital display is reporting output current for one of the outlets in that load bank; 24 additional LEDs, one near each output receptacle, will light continuously to verify power on/off status and flash to indicate that the digital display is reporting output current for just that individual receptacle. Network Link/Activity Status LED (Yellow), Network Speed LED (Green); LX Platform status LED (Green)
Switches	SELECT OUTLET and SELECT BANK switches advance the LCD screen and associated LED to display power consumption for individual output receptacles and output load banks; Press and hold the SELECT BANK button for 4 seconds to rotate the digital display 90 degrees for overhead power input; Press and hold the SELECT OUTLET button for 4 seconds to scroll the configured IP address. LX Platform Interface: Recessed reset switch for interface reboot and factory reset
Current Measurement Accuracy (Amps)	+/-1%
Voltage Measurement Accuracy (Volts)	+/-1%
Power Measurement Accuracy (Watts)	+/-1%
PHYSICAL	
Form Factors Supported	0U vertical rackmount; includes rackmount brackets. Supports toolless mounting in button-mount compatible racks
PDU Form Factor	Vertical (0U)
Shipping Dimensions (hwd / cm)	13.72 x 17.27 x 193.29
Shipping Dimensions (hwd / in.)	5.40 x 6.80 x 76.10
Shipping Weight (kg)	7.48
Shipping Weight (lbs.)	16.50
Unit Dimensions (hwd / cm)	178 x 5.6 x 6.6
Unit Dimensions (hwd / in.)	70 x 2.2 x 2.6
Unit Weight (kg)	5.44
Unit Weight (lbs.)	12
ENVIRONMENTAL	
Storage Temperature Range	-30°C to +50°C (-22°F to +122°F)
Relative Humidity	5 to 95% non-condensing
COMMUNICATIONS	
Network Monitoring Port	RJ45 Network port, RJ45 Config/Console Access port; USB A port supports a variety of Envirosense2 environmental and control modules. See Accessories>Management Hardware section for more information about these modules.
SNMP Compatibility	Pre-installed LX platform interface provides remote monitoring via Java-free HTML5 web interface, telnet, SSH, CLI and SNMP management systems
SPECIAL FEATURES	



**Tripp Lite**  
1111 W. 35th Street  
Chicago, IL 60609 USA  
Telephone: 773.869.1234  
[www.tripplite.com](http://www.tripplite.com)

High Availability PDU Features	Auto Probe Monitoring and Reboot (included)
<b>STANDARDS &amp; COMPLIANCE</b>	
Certifications	Tested to UL 60950-1 (USA, Canada), Class A (Emissions), NOM (Mexico), RoHS compliant, TAA Compliant
<b>WARRANTY</b>	
Product Warranty Period (Worldwide)	2-year limited warranty

© 2020 Tripp Lite. All rights reserved. All product and company names are trademarks or registered trademarks of their respective holders. Use of them does not imply any affiliation with or endorsement by them. Tripp Lite has a policy of continuous improvement. Specifications are subject to change without notice.

Tripp Lite uses primary and third-party agencies to test its products for compliance with standards. See a list of Tripp Lite's testing agencies:

<https://www.tripplite.com/products/product-certification-agencies>