

RCU-G-02.00-AMS-AM

RCU SERIES

IP68 SEALED USB CABLE PLUG

SPECIFICATIONS

For complete specifications see www.samtec.com?RCU

- Insulator Material:** Glass Filled Thermoplastic
- Contact Material:** Phosphor Bronze
- Current Rating:** 4.2 A per pin (1 pin powered)
- Operating Temp Range:** -20 °C to +80 °C
- Shield Material:** Phosphor Bronze
- Wire:** 20 AWG (Power)
25 AWG (Signal)
28 AWG (Drain)

Mates with:
RPCU, RPBU



Solutionator
DESIGN IN A MINUTE

- Easy sealed cable solutions
- Build a standard or flexible custom online
- Calculate performance, current rating, voltage drop
- Live chat with AccliMate™ engineers for custom options
- Variety of shells, pin sizes, signal, power, I/O interfaces
- Assembly and field kits available

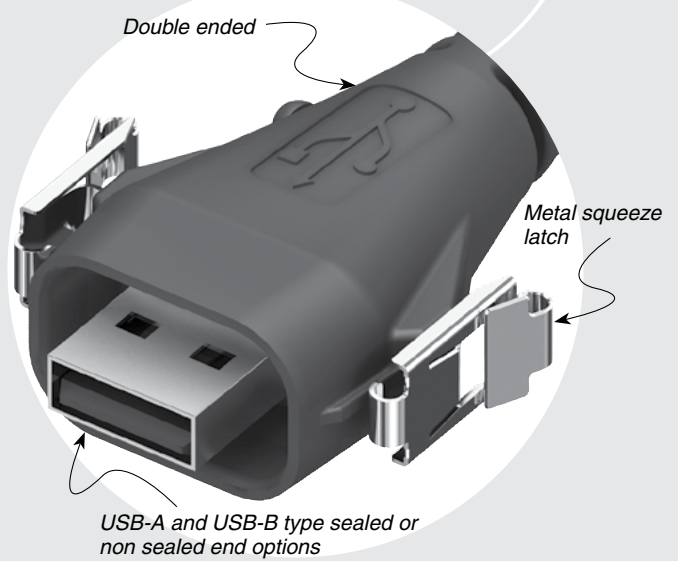

DUST CAPS

- AMS = DCA-RCU-01-01-A
- BMS = DCA-RCU-01-01-B

ALSO AVAILABLE (MOQ Required)

- Other wire lengths
 - End option 2 with -AMS, -BMS or -BM
- Contact Samtec.

RCU

PLATING

-G
= 30 μm (0.76 μm)
Gold on contact,
Nickel on shell

WIRE LENGTH

-01.00
= (1 m) 40" Cable
-02.00
= (2 m) 79" Cable
Standard lengths

END 1 OPTION

-AMS
= USB A Type,
Sealed
-BMS
= USB B Type,
Sealed

END 2 OPTION

-AM
= USB A Type,
Not Sealed
-BC
= Blunt Cut

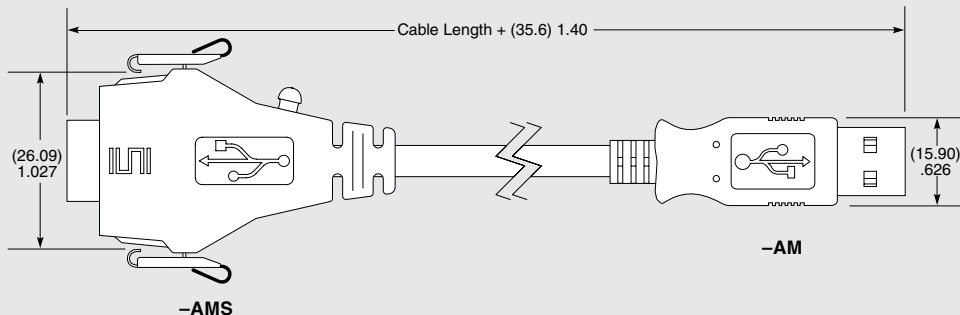

Due to technical progress, all designs, specifications and components are subject to change without notice.