

PLEASE CHECK WWW.MOLEX.COM FOR LATEST PART INFORMATION

Part Number: 0358431205
Status: Active
Overview: Automotive Bulb Sockets
Description: PT Bulb Socket Single Housing Assembly, Type A, P21W, Sealed, Gray

Documents:
3D Model
3D Model (PDF)
Drawing (PDF)
Packaging Specification PK-35843-001-001 (PDF)
RoHS Certificate of Compliance (PDF)

General
Product Family Other Sockets
Series 35843
Comments A-Type
Component Type Socket
Overview Automotive Bulb Sockets
Product Name PT Bulb Socket
UPC 756054202876

Physical
Circuits (Loaded) 2
Circuits (maximum) 2
Color - Resin Gray
Durability (mating cycles max) Contact Molex
Entry Angle Vertical
Keying to Mating Part None
Material - Resin Nylon
Net Weight 9.980/g
PCB Locator No
PCB Retention N/A
Packaging Type Bag
Pitch - Mating Interface N/A
Temperature Range - Operating -40° to +85°C
Termination Interface: Style Through Hole

Electrical
Current - Maximum per Contact 7.0A
Voltage - Maximum 12V

Material Info

Reference - Drawing Numbers
Packaging Specification PK-35843-001-001
Sales Drawing SD-35843-001

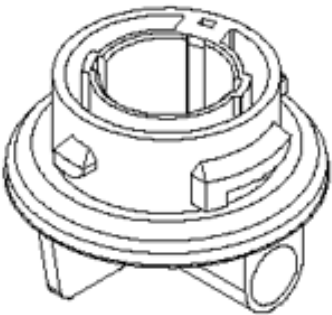

Series image - Reference only

EU ELV
Compliant
EU RoHS
Compliant
REACH SVHC
Not Contained Per -
D(2020)4578-DC (25
June 2020)
Halogen-Free
Status
Low-Halogen
For more information, please visit [Contact US](#)

China ROHS Not Relevant
ELV Compliant
RoHS Phthalates Not Contained

Search Parts in this Series
35843 Series

Mates With
Bayonet Base Bulb

Use With
Positive Terminal for PT Bulb Socket
354648000
Earth Terminal for PT Bulb
Socket 354658000
Positive Wire Seal
359030096
Earth Wire Seal 359030106

PLEASE CHECK WWW.MOLEX.COM FOR LATEST PART INFORMATION