

## 571 Series Panel Mounted Fuseholders

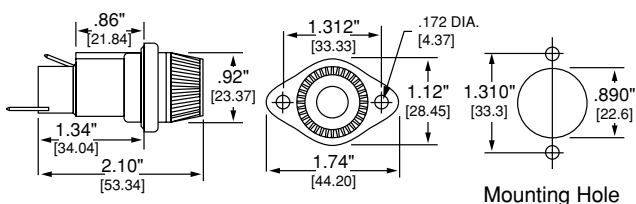

Panel mount fuseholders are available for supplementary or Class CC branch circuit protection. Class CC fuses have a rejection feature on one end cap which mates with the rejection feature of Littelfuse Class CC fuse blocks and fuseholders to prevent the installation of fuses with lower voltage ratings or interrupting ratings. Watertight version must be front panel mounted.



## SPECIFICATIONS

**Voltage Rating:** 600 Volts

**Ampere Rating:** 30 amperes for Class CC and Midget fuses

**Dielectric strength:** 4000 Volts

**Terminals:** Tin-plated brass combination solder and quick-connect

**Molded parts:** Black thermoplastic

**Approvals:** UL Recognized (File No. E14721) — 571 series  
UL Recognized for branch circuit protection  
— 571 OCC/RCC

CSA Certified (File No. LR7316)

## ORDERING INFORMATION

Part Number		Bottom Terminal	Fuse Length Range*	For Use With
Standard	Watertight			
571 027 571 028	571 027P 571 028P	Straight Rt. Angle	1 <sup>5</sup> / <sub>16</sub> " — 1 <sup>3</sup> / <sub>8</sub> "	Midget Fuses
571 007 571 008	571 007P 571 008P	Straight Rt. Angle	1 <sup>13</sup> / <sub>32</sub> " — 1 <sup>1</sup> / <sub>2</sub> "	Midget Fuses
571 0CC 571 RCC	571 0CCP 571 RCCP	Straight Rt. Angle	1 <sup>1</sup> / <sub>2</sub> "	Class CC Fuses

\* Fuse diameter is 1<sup>3</sup>/<sub>32</sub>".

**O-Rings:** 901-184 (body)  
901-260 (knob)

## POWR-JAW Clip Clamps



POWR-JAW clamps improve the contact between fuse and clip. The unnecessary heat from poor contact due to the loss of spring force in the clips can cause nuisance fuse opening and premature aging of surrounding components.

- High temperature phenolic resin knob designed for the most severe environments.
- 7 sizes to provide effective coverage.
- Simple design makes installation easy.

Part Number	Volts	Amperes
LCC 1	250	0-30
LCC 2	250	35-60
LCC 2	600	0-30
LCC 4	600	35-60
LCC 5	250/600	70-100
LCC 6	250/600	110-200
LCC 7	250/600	225-400
LCC 8	250/600	450-600

