

COMPACT™, TY PE 4X



INDUS TRY STANDARDS

UL 508A Listed; Type 4, 4X, 12, 13; File No. E61997

NEMA/EEMAC Type 4, 4X, 12, 13
CSA File No. 42186: Type 4, 4X, 12, 13
IEC 60529, IP66

APP LI CAT ION

For use in indoor or outdoor applications, these stylized enclosures protect components and controls in corrosive environments.

SPECIFIC AT IONS

- Cast aluminum; no welded seams or sharp corners
- Stainless steel captivated cover screws placed outside sealed area
- Two to four grounding screws located on enclosure back wall
- Oil-resistant O-ring gasket
- Tongue-and-groove sealing construction
- Threaded internal bosses provided for mounting optional panels, rails and other components
- Mounting holes provided in corners outside of gasketed area

FINIS H

RAL 7042 gray finish inside and out.

ACCESS ORIES

DIN Type Rails
Hinge Kit
Mounting Bracket Kits
DIN Type Rails

BULLETIN: CA1

Standard Product

Catalog Number	AxBxC mm/in.	External Dimensions L x W mm/in.	Conductive Panel	Panel Size D x E mm/in.	Mounting G x H mm/in.	F mm/in.	J mm/in.	K mm/in.	M mm/in.	N mm/in.	T mm/in.
CCA12128	122 x 122 x 80 4.80 x 4.80 x 3.10	122 x 122 4.80 x 4.80	CCAP1212	109 x 108 4.29 x 4.26	82 x 106 3.23 x 4.17	63 2.48	60 2.36	20 0.79	52 2.05	— —	4 0.16

A x B x C are internal dimensions.
Purchase panels separately.

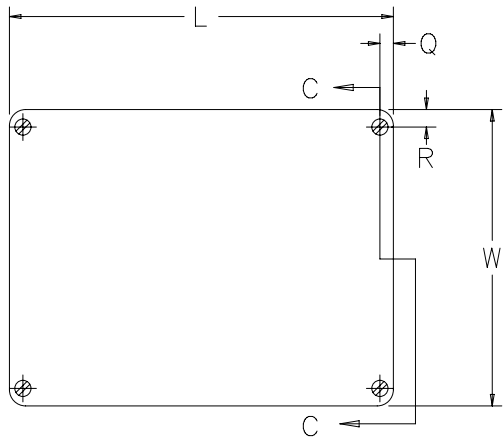

TOP VIEW

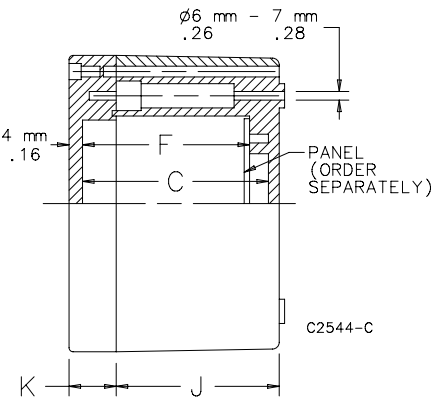

SECTION C-C

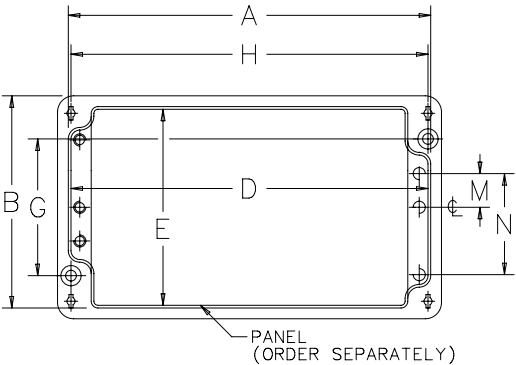
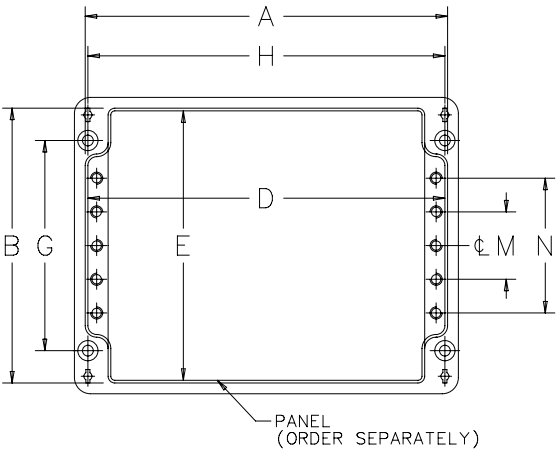

(CCA86, CCA1286, CCA1886 ONLY)

TOP VIEW WITH COVER REMOVED