

UNCONTROLLED DOCUMENT

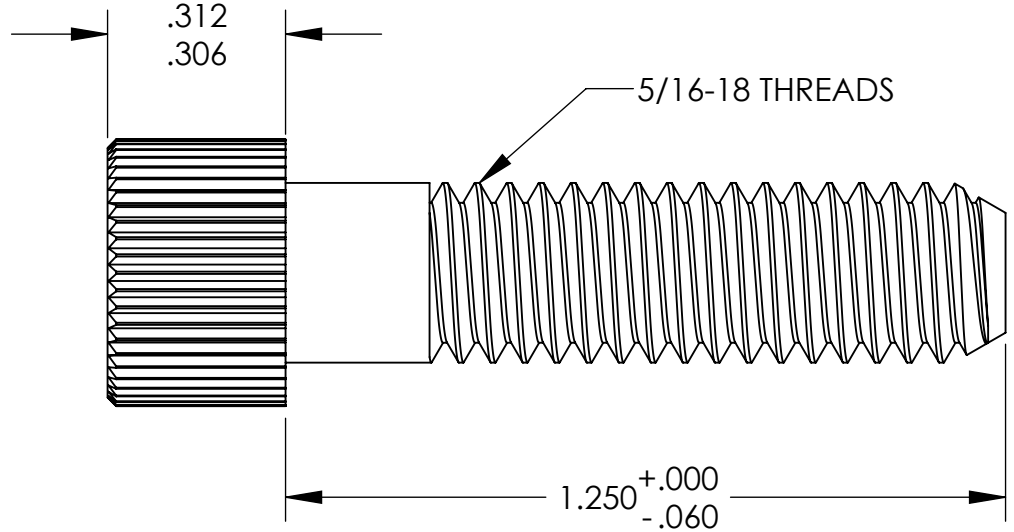
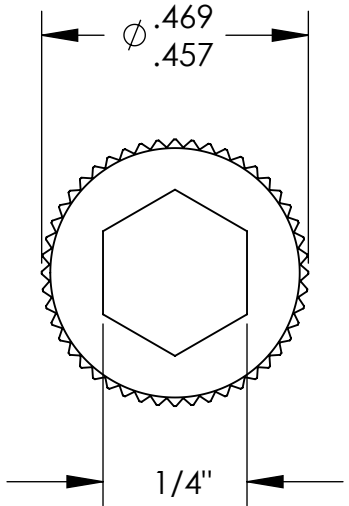

NOTES:  
.151 MINIMUM KEY ENGAGEMENT

TOLERANCES UNLESS NOTED

- ±.005 ON DIMENSIONS THRU .625
- ±.008 ON DIMENSIONS .626 THRU 1.000
- ±.010 ON DIMENSIONS 1.001 THRU 1.500
- ±.015 ON DIMENSIONS LARGER THAN 1.500
- ±.015 ON FRACTIONAL DIMENSIONS

WE RESERVE THE RIGHT  
TO DISCONTINUE ITEMS,  
CHANGE SPECIFICATIONS  
OR DESIGN AT ANY TIME  
WITHOUT NOTICE AND  
WITHOUT INCURRING  
ANY OBLIGATIONS

|   |              |           |
|---|--------------|-----------|
| PROPERTY OF   |              |           |
| MICRO PLASTICS INC.   |              |           |
| CATALOG DRAWING<br>HEX SOCKET CAP MACHINE SCREW<br>MICRO P/N 3431218125<br>DWG. # 3431218125<br>FILE SERVER\ENG\WEB |              |           |
| MATERIAL:   |              | 6/6 NYLON |
| DATE  | SCALE<br>3:1 | JDD       |