

UNCONTROLLED DOCUMENT

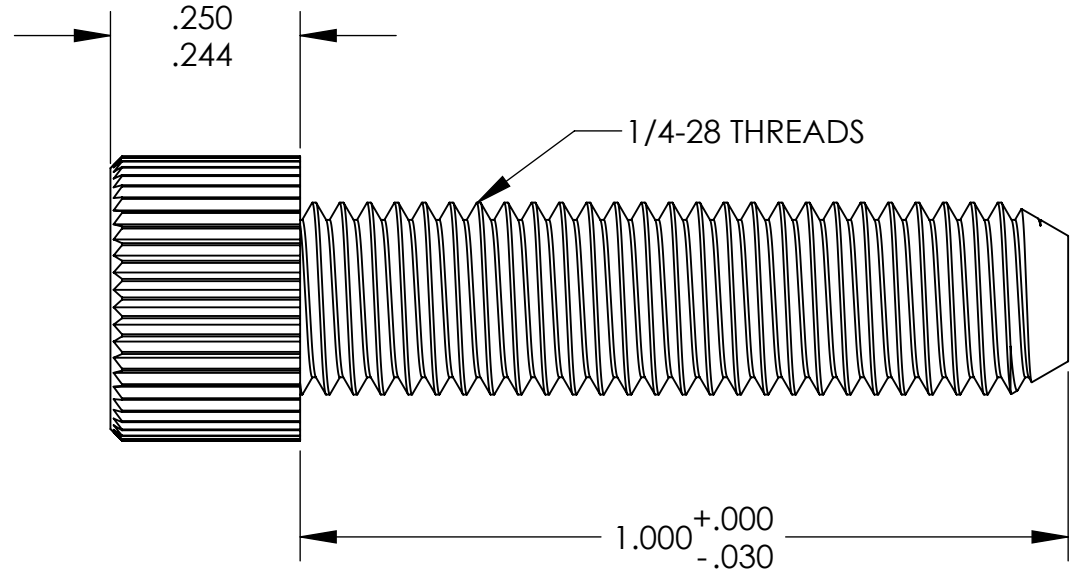
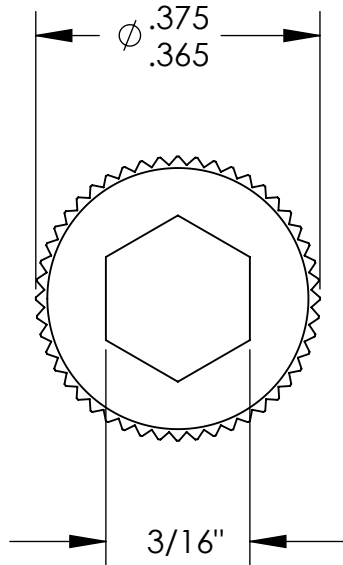

NOTES:  
.120 MINIMUM KEY ENGAGEMENT

TOLERANCES UNLESS NOTED

±.005 ON DIMENSIONS THRU .625  
±.008 ON DIMENSIONS .626 THRU 1.000  
±.010 ON DIMENSIONS 1.001 THRU 1.500  
±.015 ON DIMENSIONS LARGER THAN 1.500  
±.015 ON FRACTIONAL DIMENSIONS

WE RESERVE THE RIGHT  
TO DISCONTINUE ITEMS,  
CHANGE SPECIFICATIONS  
OR DESIGN AT ANY TIME  
WITHOUT NOTICE AND  
WITHOUT INCURRING  
ANY OBLIGATIONS

PROPERTY OF  
**MICRO PLASTICS INC.**

CATALOG DRAWING  
HEX SOCKET CAP MACHINE SCREW  
MICRO P/N 3425280100  
DWG. # 3425280100  
FILE SERVER\ENG\WEB

MATERIAL: 6/6 NYLON

DATE

SCALE  
4:1

*JDD*