

AVAILABLE BY SPECIAL ORDER - NAFTA REGION ONLY

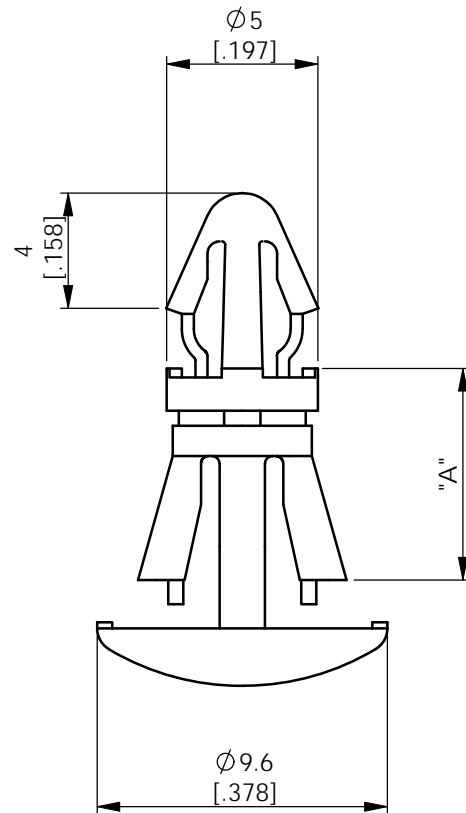

TO SNAP LOCK INTO A $\varnothing 4 \pm 0.08$ [.158 \pm .003] HOLE,
INTO A 1.6 [.063] NOM THICK PANEL.

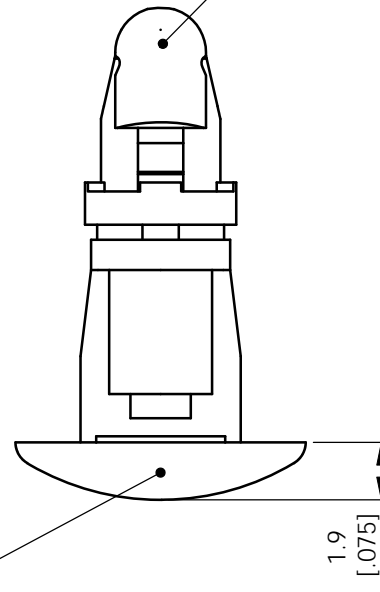

TO SNAP LOCK INTO A $\varnothing 5.4 \pm 0.08$ [.213 \pm .003] HOLE,
INTO A 1.6 [.063] NOM THICK PANEL.



RLCBSK-14-YY	14.0 [.551]
RLCBSK-12-YY	12.0 [.472]
RLCBSK-10-YY	10.0 [.394]
RLCBSK-8-YY	8.0 [.315]
RLCBSK-7-YY	7.0 [.276]
RLCBSK-6-YY	6.0 [.236]
PART NUMBER	"A" DIMENSION

RLCBSK-X-19	NYLON 6/6 UL94-V0 (RMS-19)
RLCBSK-X-01	NYLON 6/6 UL94-V2 (RMS-01)
PART NUMBER	MATERIAL

NOTES:
1a) METRIC PRIMARY UNITS:mm
1b) IMPERIAL SECONDARY UNITS: [inches]
2) PARTS AVAILABLE IN BLACK BY SPECIAL
ORDER ADD BK TO END OF PART NUMBER.
E.G. RLCBSK-6-01BK

INFORMATION CONTAINED IN THIS DOCUMENT IS CONFIDENTIAL TO
RICHCO INTERNATIONAL Co. Ltd. AND MAY NOT BE DISCLOSED OR
REPRODUCED IN WHOLE OR PART WITHOUT THEIR WRITTEN CONSENT.



GENERAL TOLERANCES ± 0.25 [.010]
UNLESS OTHERWISE STATED
ANGULAR $\pm 1^\circ$



MATERIAL:		SEE TABLE		COLOUR:		NATURAL	
DESCRIPTION:		REVERSE LOCKING CIRCUIT BOARD SUPPORT		PART No:		See Table	
DRG No:		08-110		NPR No:		NA	
SHEET SIZE		A4		SCALE		NTS	
DRN	DATE	CHKD	DATE	SCALE	SHEET No.		
OW	12/11/08	TC	12/11/08	NTS	1 OF 1		