

# EAO – Your Expert Partner for Human Machine Interfaces

## 99-251.837D - Keylock switch 2 positions

### 99-251.837D - Keylock switch 2 positions

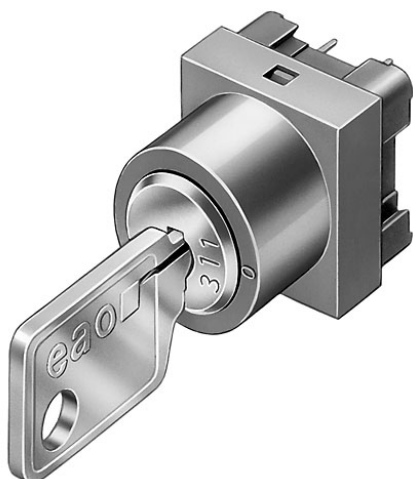

*Attention: The preview is based on a sample product. This can differ from your current configuration.*

#### Front

Front dimension Ø 17 mm

#### Other Attributes

Weight 0.017 kg

#### Operating-/Indication part

Switching angle  $C = 90^\circ$

#### IP-Rating

Front protection IP 40

#### Connection Method

Terminal PCB

#### Actuator

Key remove A + C  
Switching action Rest - Maintained

#### Switching element

Rotary positions 2  
Switching system Low-level element  
Contacts 2 NO  
Switching voltage 42 V AC/DC  
Switching current 0.1 A  
Contact material Gold

#### Function

Keylock switch

# EAO – Your Expert Partner for Human Machine Interfaces

## 99-251.837D - Keylock switch 2 positions

### Mounting cut-outs

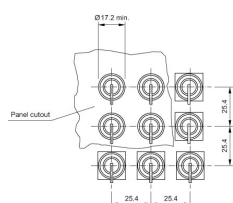

### Wiring diagram



### Component layout

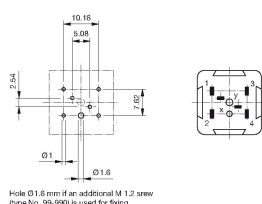

### Switching positions

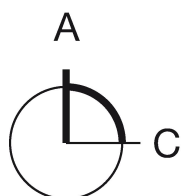

### Additional information

Lock numbers 311, lock type DOM

Optional lock numbers on request

### Legend

Contacts: NO = Normally open

Switching action: A = Rest, C = Maintained