

# EAO – Your Expert Partner for Human Machine Interfaces

## 732-.401-W0 - Keylock switch actuator 3 positions square

### 732-.401-W0 - Keylock switch actuator 3 positions square



*Attention: The preview is based on a sample product. This can differ from your current configuration.*

#### Mounting

Mounting cut-out Design 21 mm x 21 mm  
flush

#### Front

Front dimension 24 mm x 24 mm  
Front shape square

#### Other Attributes

Weight 0,023 kg

#### Operating-/Indication part

Switching angle

#### IP-Rating

Front protection IP65

#### Connection Method

Terminal Solder 2.8 x 0.5 mm

#### Actuator

Switching action Momentary - Rest(a) - Momentary

#### Switching element

Rotary positions 3  
Switching system Snap-action switching element  
Contacts 2 NC + 2 NO  
Switching current 5 A  
Contact material  
Switching voltage 250 V AC

#### Function

Keylock switch

# EAO – Your Expert Partner for Human Machine Interfaces

## 732-.401-W0 - Keylock switch actuator 3 positions square

### Dimensions

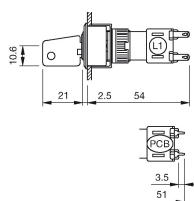

### Mounting cut-outs

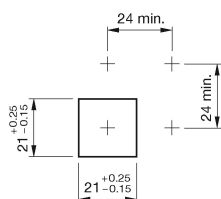

### Wiring diagram

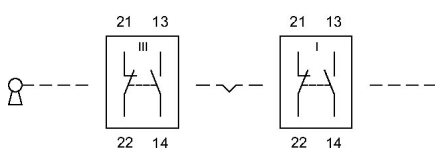

### Switching positions

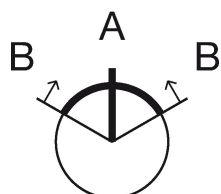

### Additional information

Standard lock B2 300

Further lock numbers see «Technical data»

### Legend

Contacts: NC = Normally closed, NO = Normally open

Switching action: A = Rest, B = Momentary