

# EAO – Your Expert Partner for Human Machine Interfaces

## 51-135.025D2F - Keylock switch 2 positions round - Actuator

### 51-135.025D2F - Keylock switch 2 positions round - Actuator



*Attention: The preview is based on a sample product. This can differ from your current configuration.*

#### Attribute

|                     |                               |
|---------------------|-------------------------------|
| Design              | flush                         |
| Front dimension     | Ø 25 mm                       |
| Front form          | round                         |
| IP front protection | IP65                          |
| Contacts            | 1 NC / 1 NO                   |
| Contact material    | Gold                          |
| Rotary positions    | 2                             |
| Switching action    | Rest (a) - Maintained (a)     |
| Switching angle     | 90° right                     |
| Switching current   | 5 A                           |
| Switching system    | Snap-action switching element |
| Switching voltage   | 250 V                         |
| Terminal            | Soldering terminal            |
| Weight              | 0.026 kg                      |
| Switching rating    | 250 V @ 5 A                   |

#### Function

Keylock switch

# EAO – Your Expert Partner for Human Machine Interfaces

## 51-135.025D2F - Keylock switch 2 positions round - Actuator

### Dimensions

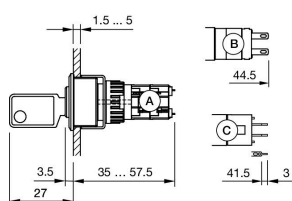

### Mounting cut-outs

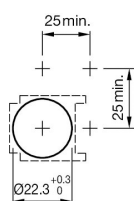

### Wiring diagrams

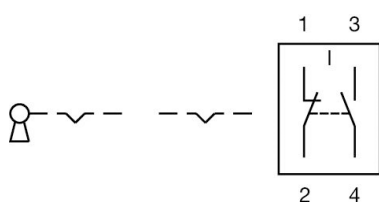

### Additional information

Standard lock: DOM 311

Contacts: NC = Normally closed, NO = Normally open

a = Key remove

Standard lock: DOM 311

Contacts: NC = Normally closed, NO = Normally open

a = Key remove