

# EAO – Your Expert Partner for Human Machine Interfaces

## 14-418.036K - Keylock switch actuator 2 positions

### 14-418.036K - Keylock switch actuator 2 positions

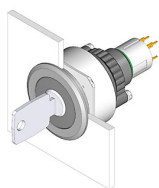

*Attention: The preview is based on a sample product. This can differ from your current configuration.*

#### Mounting

Design	flush
Mounting cut-out	Ø 30,5 mm

#### Front

Front dimension	Ø 35 mm
Front shape	round

#### Other Attributes

Weight	0,030 kg
--------	----------

#### Operating-/Indication part

Switching angle	90° right
-----------------	-----------

#### IP-Rating

Front protection	IP65
------------------	------

#### Connection Method

Terminal	Universal 2.0 x 0.5 mm
----------	------------------------

#### Actuator

Switching action	Rest - Maintain(a)
------------------	--------------------

#### Switching element

Rotary positions	2
Switching system	Low-level element
Contacts	1 NC + 1 NO
Switching voltage	42 V AC/DC
Switching current	0.1 A
Contact material	

#### Function

Keylock switch	
----------------	--

# EAO – Your Expert Partner for Human Machine Interfaces

## 14-418.036K - Keylock switch actuator 2 positions

## Dimensions

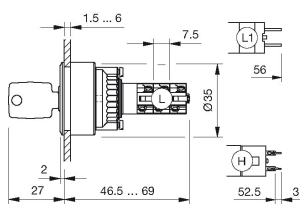

H = Universal terminal 2.0 x 0.5 mm

## Mounting cut-outs

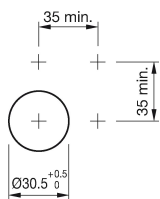

## Wiring diagram



## Component layout

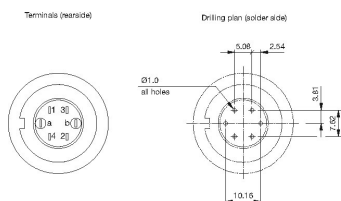

### Additional information

Lock numbers 1001, lock type KABA

Two keys are supplied with each keylock switch.

Optional lock numbers on request

### Legend

Contacts: NC = Normally closed, NO = Normally open

Switching action: A = Rest, C = Maintained

# EAO – Your Expert Partner for **Human Machine Interfaces**

14-418.036K - Keylock switch actuator 2 positions

## Switching positions

