

EZ-LIGHT® S18L Color General-Purpose Indicators



more sensors, more solutions

DC-Operated LED Indicators with One, Two, or Three Colors

For the latest technical information about this product, including specifications, dimensions, and wiring, see www.BannerEngineering.com

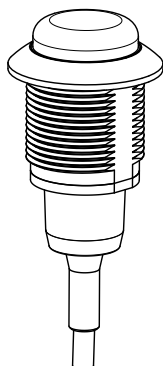

- Up to three independent colors in one unit
- Translucent face appears gray when off to avoid false indication
- M12 Euro connector models available for plug and play indication
- Wide 180° field of view
- Wide 10 to 30V dc operating range allows for use in battery powered mobile applications
- Available with PNP or NPN input, depending on model
- IP69K rated to withstand harsh wash-down environments
- Wide operating range of -40° to +50° C
- Daylight visible models with a clear cover and more focused light output provide greater visibility in high ambient light conditions

Models

Table 1: Standard Models

Family	Color 1	Color 2	Color 3	Input	Connector
S18L	G	R	Y	P	Q
MODEL KEY	G = Green R = Red Y = Yellow B = Blue W = White O = Orange T = Turquoise V = Violet M = Magenta X = No color in this position			P = PNP N = NPN	Q = 4 pin Euro QD Blank = 2 meter cable QP = Euro Pigtail QD T = 4 screw terminals

Table 2: Daylight Visible Models

Family	Color 1	Color 2	Color 3	Input	Connector
S18DL	G	R	Y	P	Q
MODEL KEY	G = Green R = Red Y = Yellow B = Blue W = White O = Orange X = No color in this position			P = PNP N = NPN	Q = 4 pin Euro QD Blank = 2 meter cable QP = Euro Pigtail QD T = 4 screw terminals

Example Model	Indicators	Input	Connector Type
S18LGRYP	Green, Red, Yellow	PNP	blank = 2 m cable
S18LGXXPQ	Green	PNP/NPN	4-pin Euro QD
S18LGRXPQP	Green, Red	PNP	Euro Pigtail QD
S18LGRYPT	Green, Red, Yellow	PNP	4 screw terminals



NOTE: Single color models should be ordered as PNP models but can be wired for either PNP or NPN input.

**WARNING: Not To Be Used for Personnel Protection**

Never use this product as a sensing device for personnel protection. Doing so could lead to serious injury or death. This product does NOT include the self-checking redundant circuitry necessary to allow its use in personnel safety applications. A sensor failure or malfunction can cause either an energized or de-energized sensor output condition.

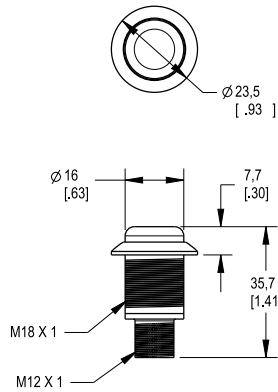
Dimensions

QD Models

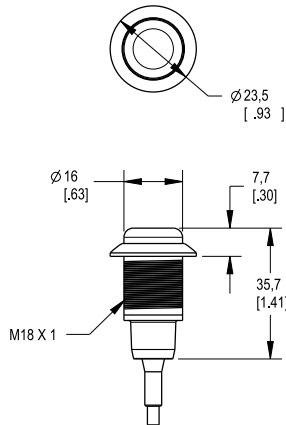

Cable Models

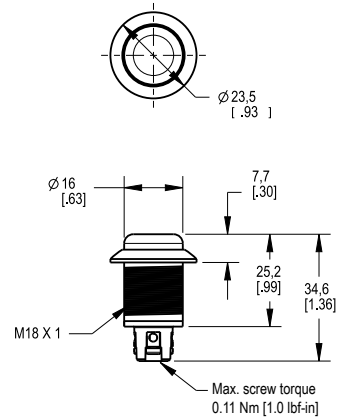

Terminal Models

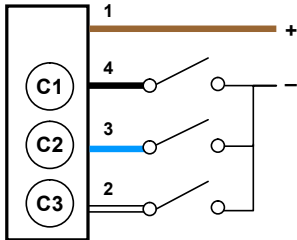
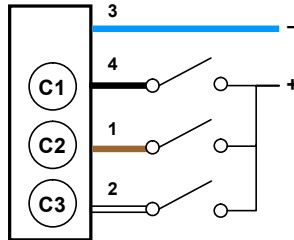
Multi Color Wiring**NPN****PNP****Wiring Key:**

- 1 = Brown
- 2 = White
- 3 = Blue
- 4 = Black

Color Key:

- C1 = Color 1
- C2 = Color 2
- C3 = Color 3

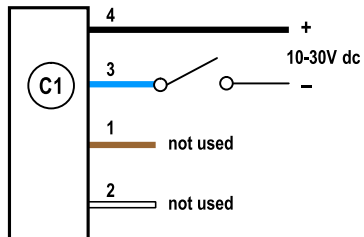
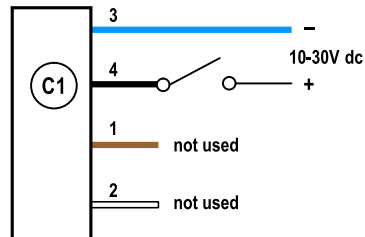
Single Color Wiring**NPN****PNP**

Specifications

Supply and Voltage Current

10 to 30V dc at 25 mA max. per LED color

Indicators

LEDs are independently selected; 1, 2, or 3 colors, depending on model.
For other colors/combinations, contact Factory for availability

Standard Models: Entire translucent dome provides even indication
viewable from over 180 degrees

Daylight Visible Models: Clear dome and more focused light provides
even brighter indication when used in high ambient light areas

Input Response Time

Indicator ON/OFF: 1 ms max

Construction

UV stabilized polycarbonate housing
PBT mounting nut max torque 2.3 N·m (20 lbf·in)
Nitrile sealing washer

Connections

4-pin Euro-style integral QD (Q), 150 mm (5.9 in) PVC pigtail QD (QP),
or 4-wire, 2 m (6.5 ft) PVC integral cable, 4 color-coded screw terminals
for up to 14 AWG wire, depending on model, screw terminal max. torque
0.11 N·m (1.0 lbf·in)

Environmental Rating

Rated IEC IP67, and IP69K, per DIN 40050-9. Cabled models also meet
IP69K if the cable and cable entrance are protected from high-pressure
spray. Indicator side of terminal models meet IP67, and IP69K when in-
stalled in an enclosure. Screw connection points meet IP00

Operating Conditions

-40° to +50° C (-40° to +122° F)
Limited to one color on at a time

Certifications



Cordsets

4-Pin Threaded M12/Euro-Style Cordsets				
Model	Length	Style	Dimensions	Pinout
MQDC-406	1.83 m (6 ft)	Straight		 1 = Brown 2 = White 3 = Blue 4 = Black
MQDC-415	4.57 m (15 ft)			
MQDC-430	9.14 m (30 ft)			
MQDC-450	15.2 m (50 ft)			
MQDC-406RA	1.83 m (6 ft)	Right-Angle		 1 = Brown 2 = White 3 = Blue 4 = Black
MQDC-415RA	4.57 m (15 ft)			
MQDC-430RA	9.14 m (30 ft)			
MQDC-450RA	15.2 m (50 ft)			

Mounting Brackets

<p>SMB18A</p> <ul style="list-style-type: none"> Right-angle mounting bracket with a curved slot for versatile orientation 12-ga. stainless steel 18 mm sensor mounting hole Clearance for M4 (#8) hardware <p>Hole center spacing: A to B = 24.2 Hole size: A = ø 4.6, B = 17.0 x 4.6, C = ø 18.5</p>	<p>SMBAMS18P</p> <ul style="list-style-type: none"> Flat SMBAMS series bracket with 18 mm hole for mounting sensors Articulation slots for 90+° rotation 12-ga. (2.6 mm) cold-rolled steel <p>Hole center spacing: A = 26.0, A to B = 13.0 Hole size: A = 26.8 x 7.0, B = ø 6.5, C = ø 19.0</p>
---	---

SMB18AFA..

- Protective, swivel bracket with tilt and pan movement for precision adjustment
- Easy sensor mounting to extruded rail T-slots
- Metric and inch size bolts available
- Mounting hole for 18 mm sensors

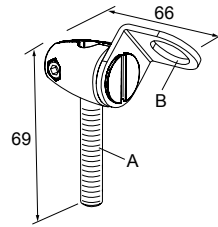

Hole size: B = \varnothing 18.1

Model	Bolt Thread (A)
SMB18AFA	3/8 - 16 x 2"
SMB18AFAM10	M10 - 1.5 x 50

SMBAMS18RA

- Right-angle SMBAMS series bracket with 18 mm hole for mounting sensors
- Articulation slots for 90+° rotation
- 12-ga. (2.6 mm) cold-rolled steel

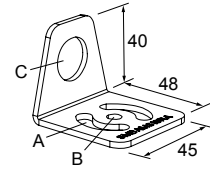

Hole center spacing: A = 26.0, A to B = 13.0

Hole size: A = 26.8 x 7.0, B = \varnothing 6.5, C = \varnothing 19.0

SMBC18

- 18 mm sensor mounting hole
- Snaps onto 28 mm diameter structural framing

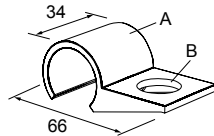

A = \varnothing 26.9 mm

Hole size: B = \varnothing 18.4

LMB1822FM

- Adaptor for mounting the S18L into standard 22 mm holes
- Includes adaptor, nut, and gasket

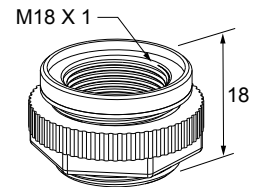
**Banner Engineering Corp Limited Warranty**

Banner Engineering Corp. warrants its products to be free from defects in material and workmanship for one year following the date of shipment. Banner Engineering Corp. will repair or replace, free of charge, any product of its manufacture which, at the time it is returned to the factory, is found to have been defective during the warranty period. This warranty does not cover damage or liability for misuse, abuse, or the improper application or installation of the Banner product.

THIS LIMITED WARRANTY IS EXCLUSIVE AND IN LIEU OF ALL OTHER WARRANTIES WHETHER EXPRESS OR IMPLIED (INCLUDING, WITHOUT LIMITATION, ANY WARRANTY OF MERCHANTABILITY OR FITNESS FOR A PARTICULAR PURPOSE), AND WHETHER ARISING UNDER COURSE OF PERFORMANCE, COURSE OF DEALING OR TRADE USAGE.

This Warranty is exclusive and limited to repair or, at the discretion of Banner Engineering Corp., replacement. **IN NO EVENT SHALL BANNER ENGINEERING CORP. BE LIABLE TO BUYER OR ANY OTHER PERSON OR ENTITY FOR ANY EXTRA COSTS, EXPENSES, LOSSES, LOSS OF PROFITS, OR ANY INCIDENTAL, CONSEQUENTIAL OR SPECIAL DAMAGES RESULTING FROM ANY PRODUCT DEFECT OR FROM THE USE OR INABILITY TO USE THE PRODUCT, WHETHER ARISING IN CONTRACT OR WARRANTY, STATUTE, TORT, STRICT LIABILITY, NEGLIGENCE, OR OTHERWISE.**

Banner Engineering Corp. reserves the right to change, modify or improve the design of the product without assuming any obligations or liabilities relating to any product previously manufactured by Banner Engineering Corp.